

## PROLONGADOR DE IMPACTO 1/2"

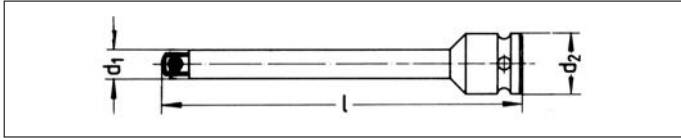

DIN 3121/ISO 1174

- Acabado: Negro mate.

D1 mm	D2 mm	L1 mm	L mm	Art. Nº	U/E
25	15	75	3"	<b>0714 13 22</b>	1
		100	6"	<b>0714 13 23</b>	

## VASO TORX 1/2" CORTO

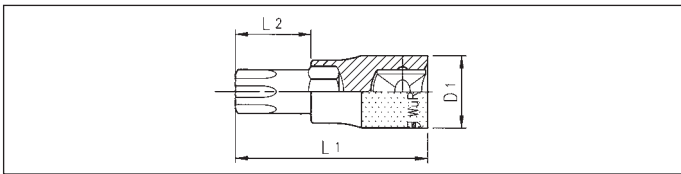

DIN 3121/ISO 1174

mm	L1 mm	D1 mm	D2 mm	Art. Nº	U/E	
40	6,65	40	6.6	25	<b>0715 136 40</b>	1

## VASOS DE IMPACTO 3/4"

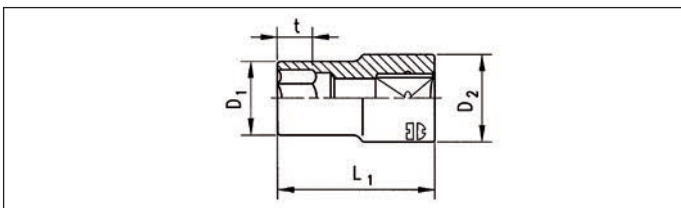

DIN 3129/DIN 3121/ISO 1174

- Acabado: Negro mate.

### Versión corta

mm	L1 mm	D1 mm	D2 mm	t mm	Art. Nº	U/E
24	50	39	44	16	<b>0714 14 04</b>	1
27		43			<b>0714 14 05</b>	
30	54	47		23	<b>0714 14 06</b>	
32	56	49			<b>0714 14 07</b>	
36		54	<b>0714 14 08</b>			

### Versión larga

mm	L1 mm	D1 mm	D2 mm	t mm	Art. Nº	U/E
17	95	31	44	20	<b>0714 14 09</b>	1
19		33		23	<b>0714 14 10</b>	
22		37		23	<b>0714 14 11</b>	
24		39		51	<b>0714 14 12</b>	
27		43		62	<b>0714 14 13</b>	
30		47			<b>0714 14 14</b>	
32		49			<b>0714 14 15</b>	
33		51			<b>0714 14 151</b>	
36		54			<b>0714 14 16</b>	